

63rd & Pulaski

CHICAGO, IL 60629

For Sale

LAND PARCEL



- ▶ 0.33 AC land parcel for sale adjacent to CVS Pharmacy
- ▶ Great visibility on Pulaski Road, a strong major arterial, with exposure to \pm 48,000 VPD at the intersection
- ▶ Located less than 10 minutes from Midway International Airport
- ▶ In close proximity to several full service restaurants, QSR's, and hotels

DEMOGRAPHIC SUMMARY

	.25 Mile	.5 Mile	1 Mile
Estimated Population	3,524	13,905	50,715
Estimated Daytime Population	2,748	9,149	32,692
Estimated Households	972	3,900	14,322
Estimated Average Household Income	\$80,749	\$91,675	\$87,622

DOUG RENNER

doug.renner@baumrealty.com

312.275.3137



© 2025 All information supplied is from sources deemed reliable and is furnished subject to errors, omissions, modifications, removal of the listing from sale or lease, and to any listing conditions, including the rates and manner of payment of commissions for particular offerings, the terms of which are available to principals or duly licensed brokers. Any square footage dimensions set forth are approximate.

63rd & Pulaski

CHICAGO, IL 60629

For Sale

LAND PARCEL

SITE PLAN

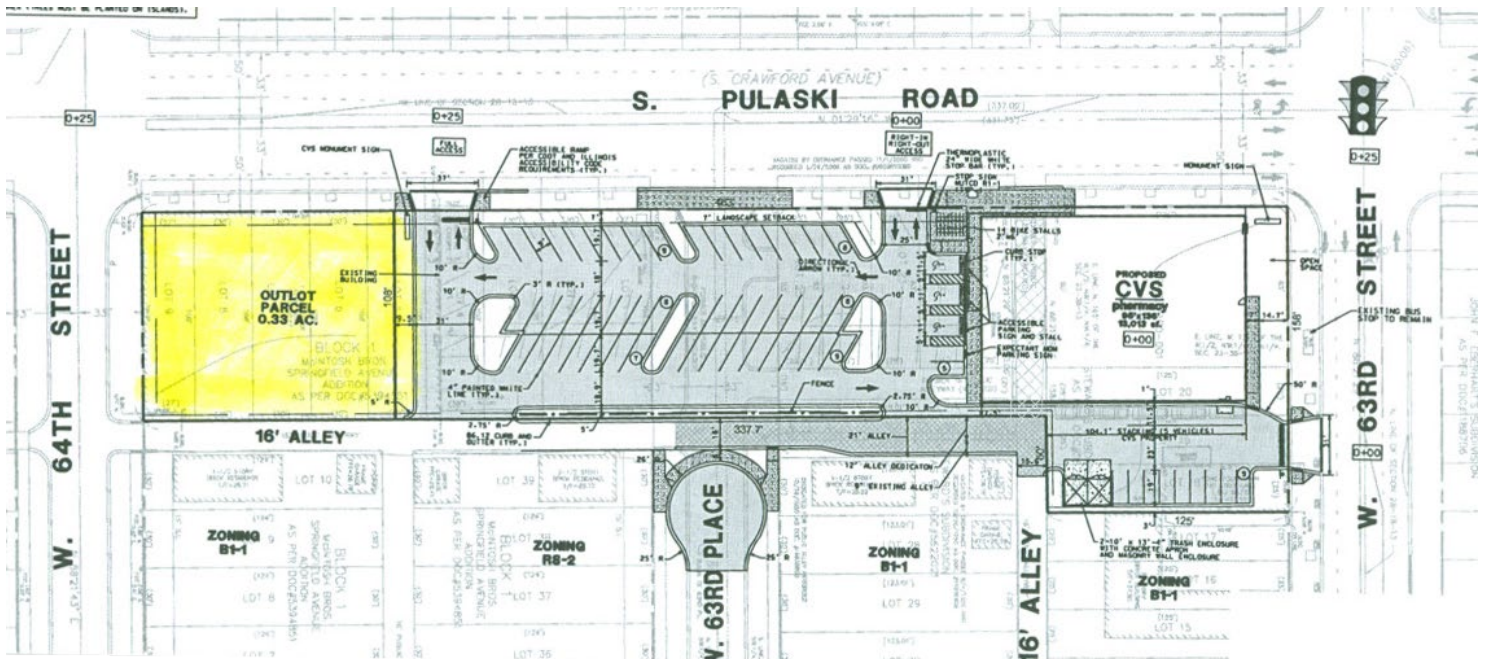

DOUG RENNER

doug.renner@baumrealty.com

312.275.3137



© 2025 All information supplied is from sources deemed reliable and is furnished subject to errors, omissions, modifications, removal of the listing from sale or lease, and to any listing conditions, including the rates and manner of payment of commissions for particular offerings, the terms of which are available to principals or duly licensed brokers. Any square footage dimensions set forth are approximate.

6351 S Pulaski Rd
Chicago, IL

