

2045-2065 S. Plum Grove Road

Rolling Meadows, IL | 60008

For Lease

Retail Property



- ▶ ±1,643 - ±3,486 SF available
- ▶ Located in CVS anchored center at the intersection of Euclid & Plum Grove in Rolling Meadows
- ▶ On-site parking lot
- ▶ Area tenants include BMO Harris Bank, Jiffy Lube, The UPS Store and Subway

DEMOGRAPHICS

	1 MILE	3 MILES	5 MILES
Estimated Population	11,196	88,515	258,921
Adj. Daytime Demographics	11,656	113,748	286,278
Estimated Households	4,226	35,962	103,675
Estimated Average Household Income	\$142,793	\$123,882	\$119,545

DOUG RENNER

312.275.3137
doug.renner@baumrealty.com

MARK FREDERICKS

312.275.3109
mark@baumrealty.com



© 2020 All information supplied is from sources deemed reliable and is furnished subject to errors, omissions, modifications, removal of the listing from sale or lease, and to any listing conditions, including the rates and manner of payment of commissions for particular offerings, the terms of which are available to principals or duly licensed brokers. Any square footage dimensions set forth are approximate.

2045-2065 S. Plum Grove Road

Rolling Meadows, IL | 60008

For Lease

Retail Property

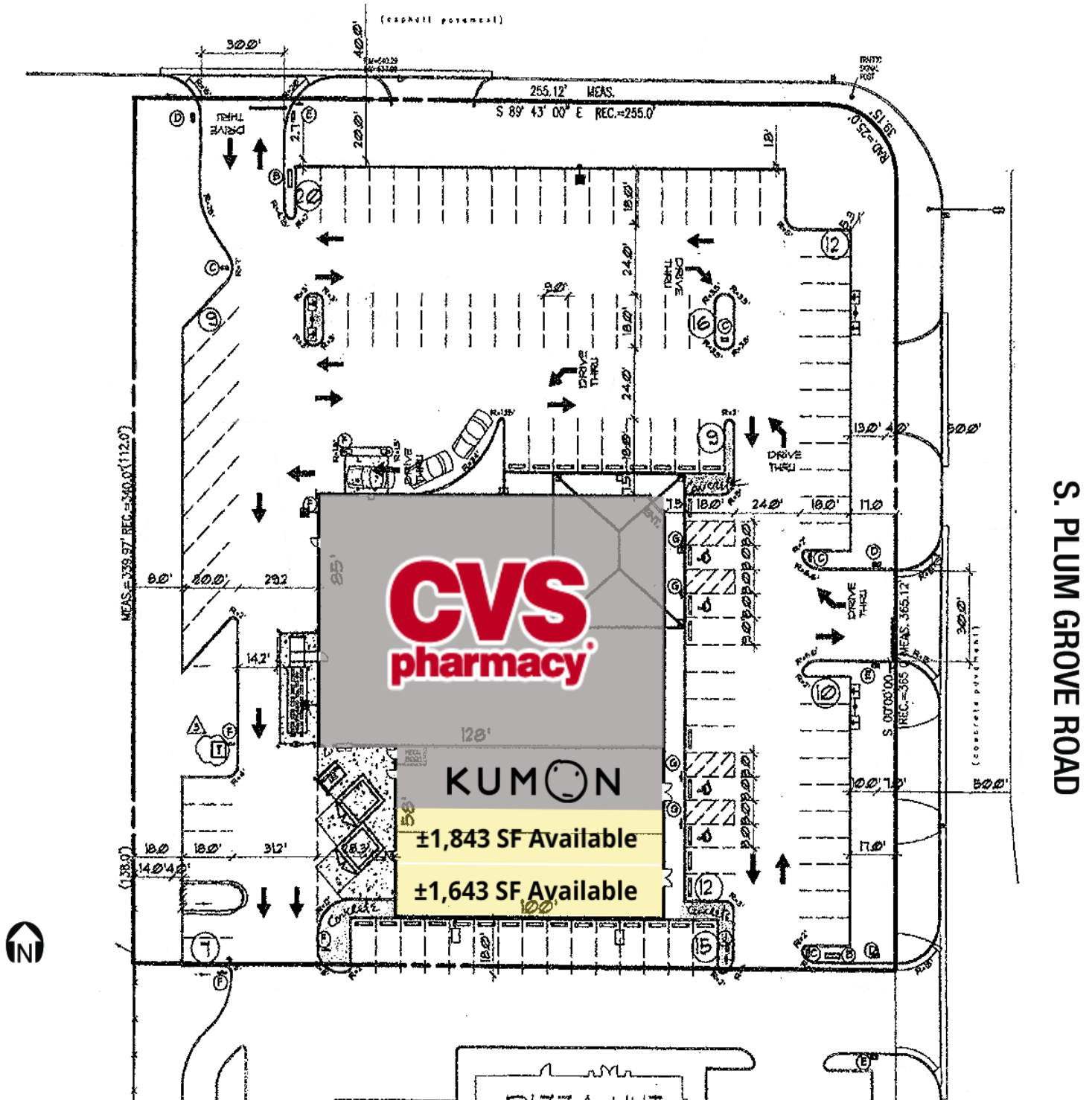

DOUG RENNER
312.275.3137
doug.renner@baumrealty.com

MARK FREDERICKS
312.275.3109
mark@baumrealty.com



© 2020 All information supplied is from sources deemed reliable and is furnished subject to errors, omissions, modifications, removal of the listing from sale or lease, and to any listing conditions, including the rates and manner of payment of commissions for particular offerings, the terms of which are available to principals or duly licensed brokers. Any square footage dimensions set forth are approximate.

2045-2065 S. Plum Grove Road
Rolling Meadows, IL 60008



Map data ©2021 Imagery ©2021, Maxar Technologies, U.S. Geological Survey, USDA Farm Service Agency



© 2020 All information supplied is from sources deemed reliable and is furnished subject to errors, omissions, modifications, removal of the listing from sale or lease, and to any listing conditions, including the rates and manner of payment of commissions for particular offerings, the terms of which are available to principals or duly licensed brokers. Any square footage dimensions set forth are approximate.

