

1965 NORTH MILWAUKEE AVENUE - CHICAGO, IL 60647

LOGAN SQUARE SECOND GENERATION COFFEE SHOP SPACE AVAILABLE



For more information contact:

MARK FREDERICKS
312.275.3109
mark@baumrealty.com

DOUG RENNER
312.275.3137
doug.renner@baumrealty.com

BROKER OWNED PROPERTY.



1965 NORTH MILWAUKEE

MARGIE'S CANDIES BUILDING · CHICAGO, IL 60647

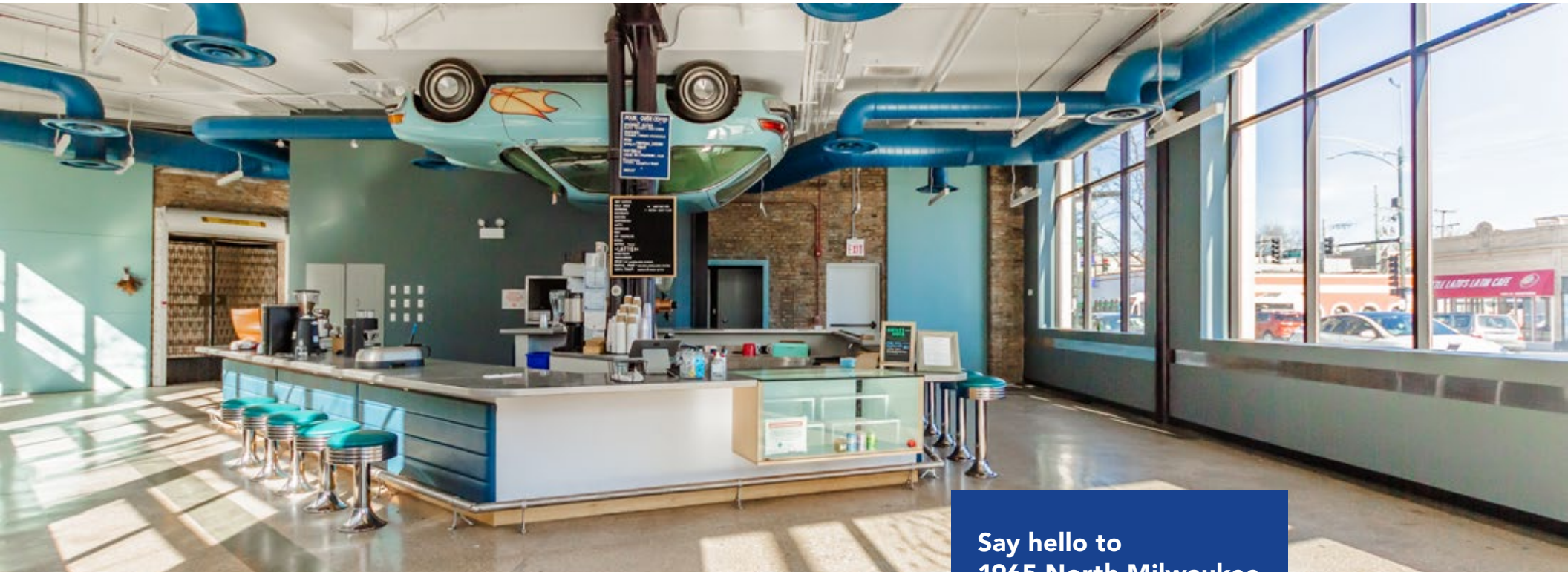

Say hello to
1965 North Milwaukee.

SITE HIGHLIGHTS

- Corner space available with highly visible frontage along Western & Milwaukee Avenues
- Home to Chicago's longest operating candy and ice cream institution, Margie's Candies
- Superior first-floor retail frontage on three streets, with visibility from each intersection and the Western Blue Line Station
- A Transit Oriented Development (TOD)
- Steps away from the Western Blue Line 'L' Station, four CTA bus routes and The 606
- Nearby retail includes Concord Music Hall, Starbucks, CrossFit Logan, Ramen Wasabi, Green Eye Lounge, Walgreens, Irazu, Remedy, Ipsento 606, Royal Palms Shuffleboard Club and many more



For leasing information contact: **Mark Fredericks** 312.275.3109 mark@baumrealty.com | **Doug Renner** 312.275.3137 doug.renner@baumrealty.com

2 | 1965 NORTH MILWAUKEE



1965 NORTH MILWAUKEE

MARGIE'S CANDIES BUILDING · CHICAGO, IL 60647

GROUND FLOOR - RETAIL PLAN

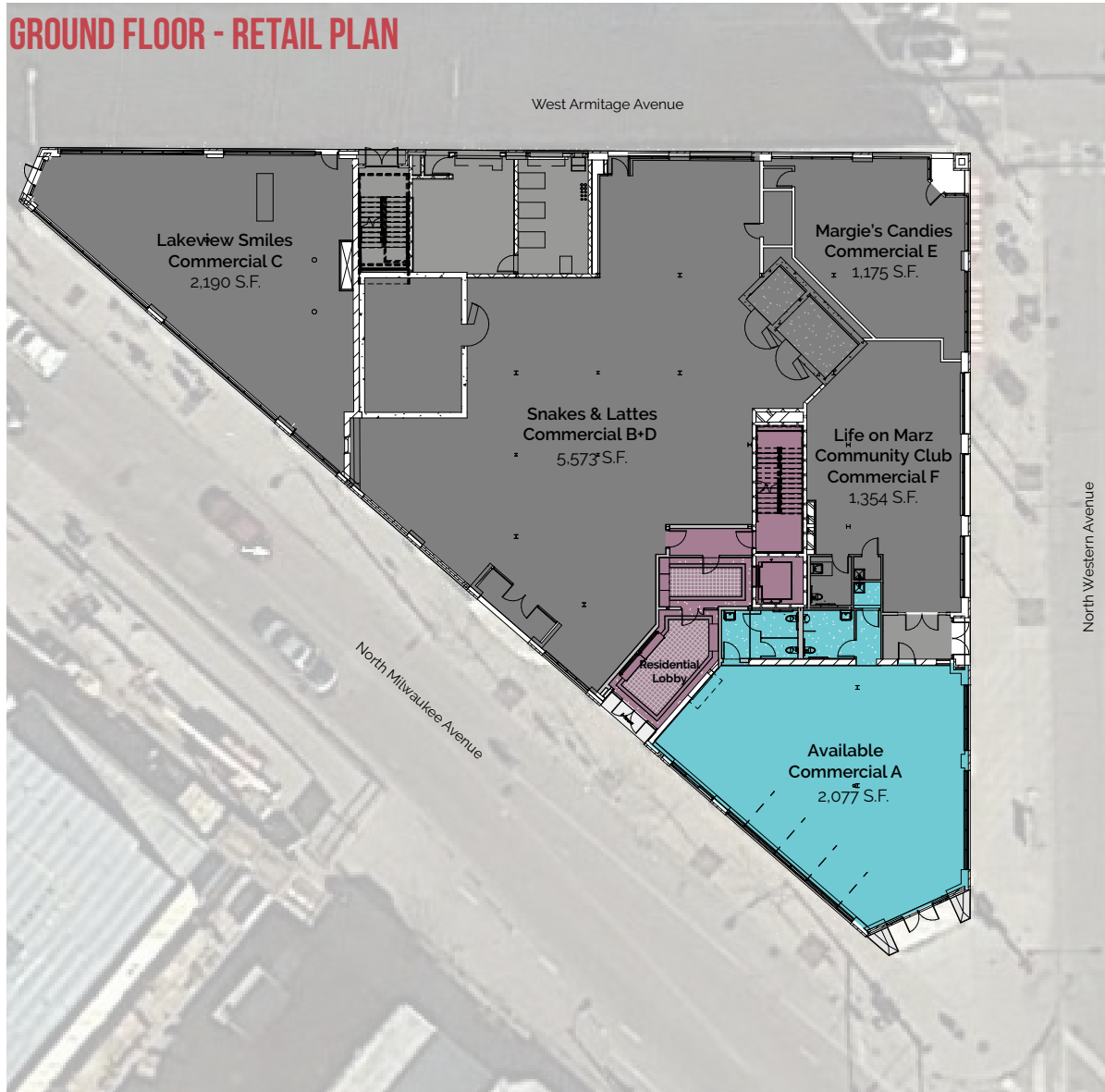

AVAILABLE RETAIL SPACE

Commercial A	2,077 SF
Commercial B + D	Snakes & Lattes
Commercial C	Lakeview Smiles
Commercial E	Margie's Candies
Commercial F	Life on Marz Community Club



Interior of Commercial A



1965 NORTH MILWAUKEE

MARGIE'S CANDIES BUILDING · CHICAGO, IL 60647

AREA INFORMATION

With the Western L Station (Blue Line - O'Hare Branch) just across the street and four bus routes, public transit is at every corner of the Margie's Candies Building.

533,788

the number of riders taking the Blue Line L via the Western station, every year

14 min to the Loop
on the blue line

30 min to O'Hare
on the Blue Line

23 min to Lincoln Square
via express bus

14 min to brown & purple
L lines by bus

AGE DISTRIBUTION - % OF POPULATION

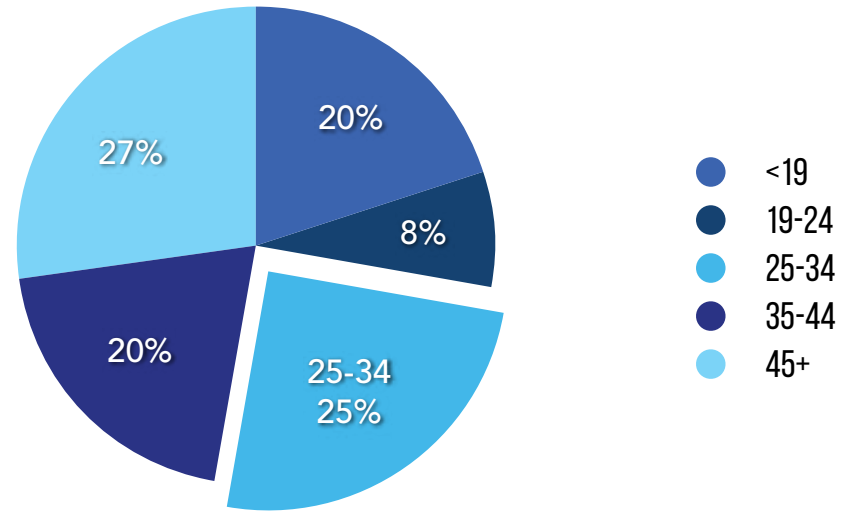

35,925+

the number of vehicles that drive past the 1965 North Milwaukee every day



\$159,329

average annual household income for residents living within one mile of 1965 North Milwaukee

63,279+

the number of people living within a mile of 1965 North Milwaukee.

Walk Score

98

2,400+

the number of bicyclists that traverse Milwaukee Avenue in a day



Chicago's famed Margie's Candies est. 1921

For leasing information contact: **Mark Fredericks** 312.275.3109 mark@baumrealty.com | **Doug Renner** 312.275.3137 doug.renner@baumrealty.com

1965 NORTH MILWAUKEE

MARGIE'S CANDIES BUILDING · CHICAGO, IL 60647



NEARBY DEVELOPMENTS

The Milwaukee Avenue development boom has produced over 2,000 apartments over the last few years, with more on the way. Including all of the proposed, under construction, and completed units along the stretch of Milwaukee Avenue between the Grand Blue Line station and the Logan Square station will eventually see the delivery of nearly **3,000 apartments and over 250,000 square feet of retail space***.

*Source: Curbed Chicago

For leasing information contact: **Mark Fredericks 312.275.3109 mark@baumrealty.com** | **Doug Renner 312.275.3137 doug.renner@baumrealty.com**

5 | 1965 NORTH MILWAUKEE



1965 NORTH MILWAUKEE AVENUE - CHICAGO, IL 60647

LOGAN SQUARE SECOND GENERATION COFFEE SHOP SPACE AVAILABLE

For more information on this exceptional retail leasing opportunity contact:

MARK FREDERICKS

312.275.3109

mark@baumrealty.com

DOUG RENNER

312.275.3137

doug.renner@baumrealty.com

BAUM REALTY GROUP

1030 W. Chicago Avenue, Suite 200

Chicago, IL 60642

www.baumrealty.com

