

63rd Street & S. Pulaski Road

CHICAGO, IL 60629

For Sale

LAND PARCEL



- ▶ Adjacent to CVS Pharmacy
- ▶ Cross parking site with great visibility on a strong major VPD arterial Pulaski Rd - (43k VPD)
- ▶ Located in close proximity to Midway International Airport and in close proximity to several full service restaurants, QSR's, and hotels

DEMOGRAPHIC SUMMARY

	.25 Mile	.5 Mile	1 Mile
Estimated Population	3,427	13,794	52,529
Estimated Daytime Population	2,624	10,192	10,192
Estimated Households	890	3,338	12,848
Estimated Average Household Income	\$70,077	\$70,040	\$69,110

DOUG RENNER

doug.renner@baumrealty.com

312.275.3137



© 2022 All information supplied is from sources deemed reliable and is furnished subject to errors, omissions, modifications, removal of the listing from sale or lease, and to any listing conditions, including the rates and manner of payment of commissions for particular offerings, the terms of which are available to principals or duly licensed brokers. Any square footage dimensions set forth are approximate.

63rd Street & S. Pulaski Road

CHICAGO, IL 60629

For Sale

LAND PARCEL

SITE PLAN

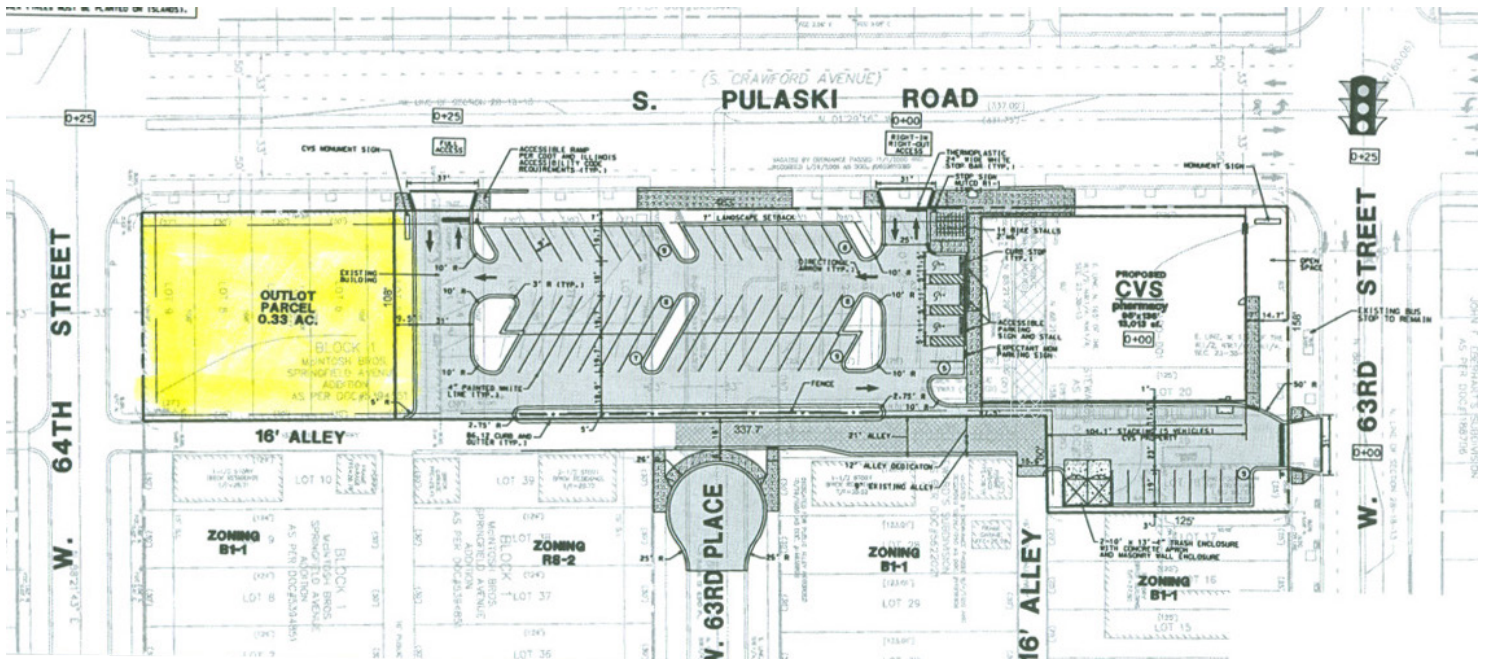

DOUG RENNER

doug.renner@baumrealty.com

312.275.3137



© 2022 All information supplied is from sources deemed reliable and is furnished subject to errors, omissions, modifications, removal of the listing from sale or lease, and to any listing conditions, including the rates and manner of payment of commissions for particular offerings, the terms of which are available to principals or duly licensed brokers. Any square footage dimensions set forth are approximate.

6351 S Pulaski Rd
Chicago, IL

