

**WHOLE BUILDING OPPORTUNITY · 4,500-72,000 SQUARE FEET AVAILABLE**



**13 NORTH  
08 ELSTON**





# OUT LOOK

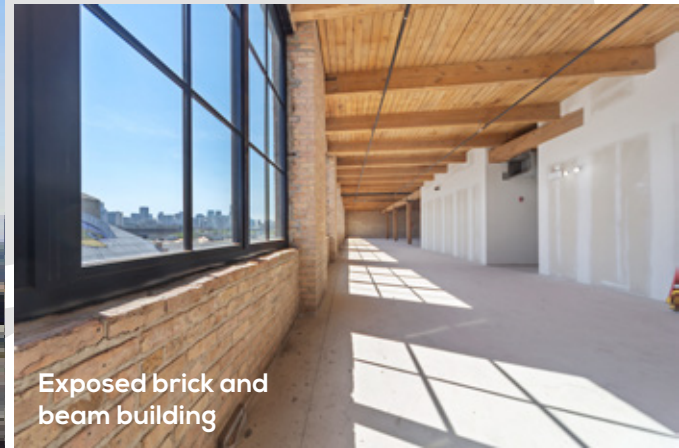

Exposed brick and beam building

1308 NORTH ELSTON  
DELIVERS **INCREDIBLE  
LIGHT, UNOBSTRUCTED  
VIEWS**, AND A **BREATH OF  
FRESH AIR** INTO THE NEAR  
NORTH OFFICE MARKET.

**13  
08** NORTH  
ELSTON



DOWNTOWN CHICAGO

Visible to over 400,000 commuters daily



84,163



RIDERS PER DAY

ON UNION PACIFIC NORTH AND NORTHWEST LINES

13 NORTH ELSTON 08

Metra®



325,200

CARS PER DAY ALONG I-90/94

SUPERIOR

VISIBILITY

13 NORTH ELSTON 08



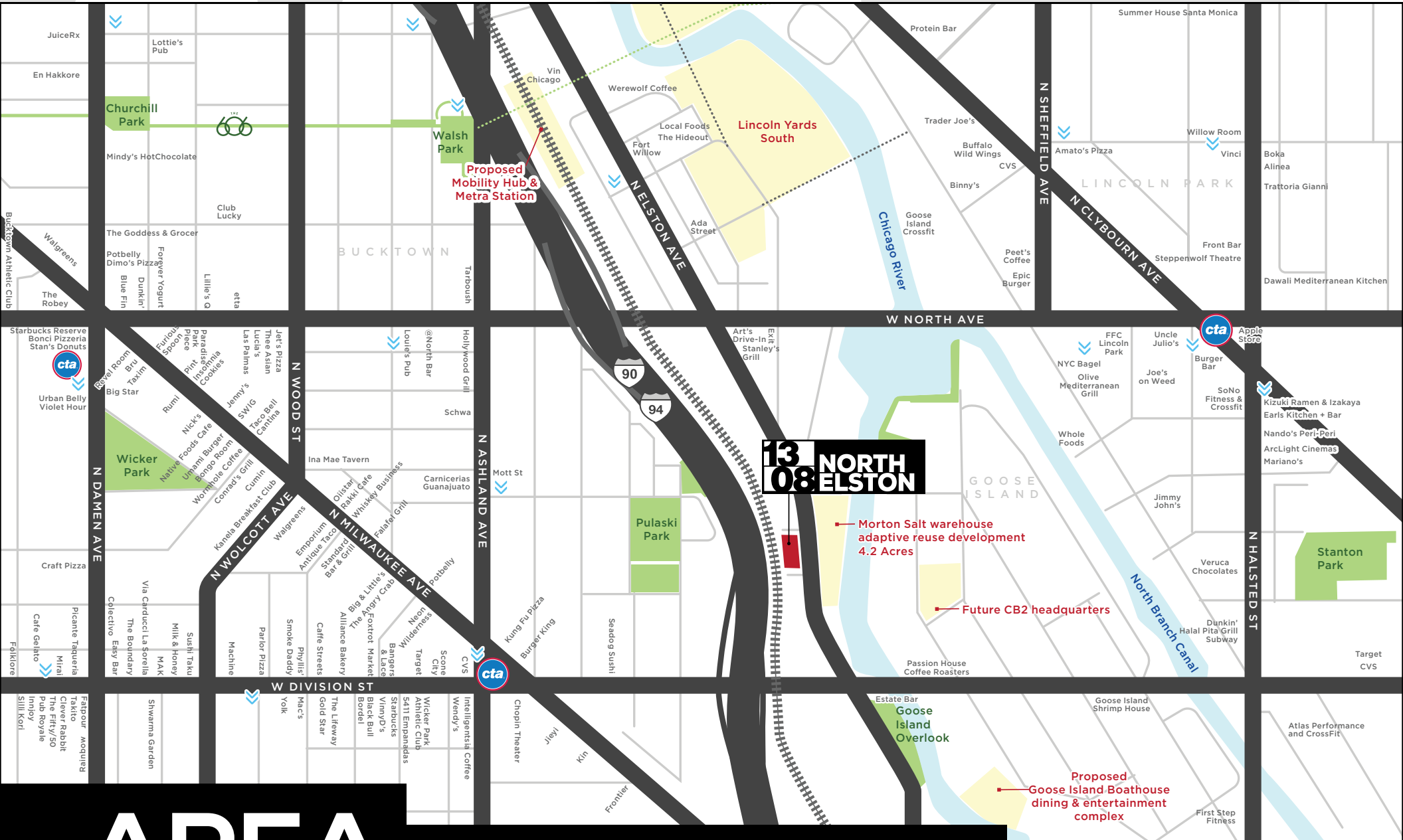

# AREA AMENITIES





# BUILDING LOBBY



# PROPOSED TRANSPORTATION SHUTTLE ROUTE



**Metra Clybourn Stop  
(Union Pacific  
Northwest Line)**



**CTA North/  
Clybourn Red Line**



**CTA Division Blue  
Line and #70 Bus**

**13  
08  
NORTH  
ELSTON**

**13  
08  
NORTH  
ELSTON**

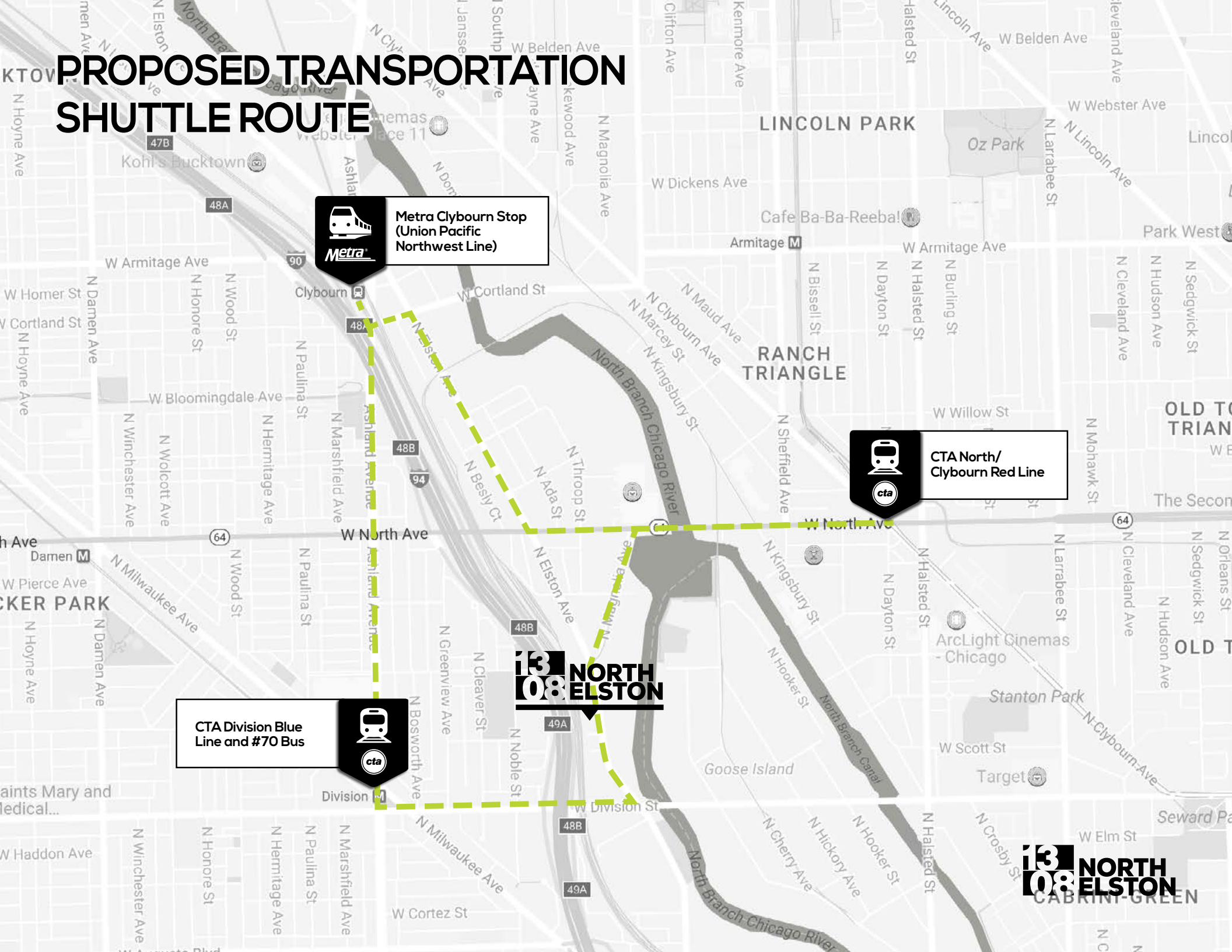



**CEILING HEIGHTS  
RANGE FROM  
12 TO 14 FEET**

**12' - 14'**

**SPACE**



**13  
08 NORTH  
ELSTON**

# SITE PLAN

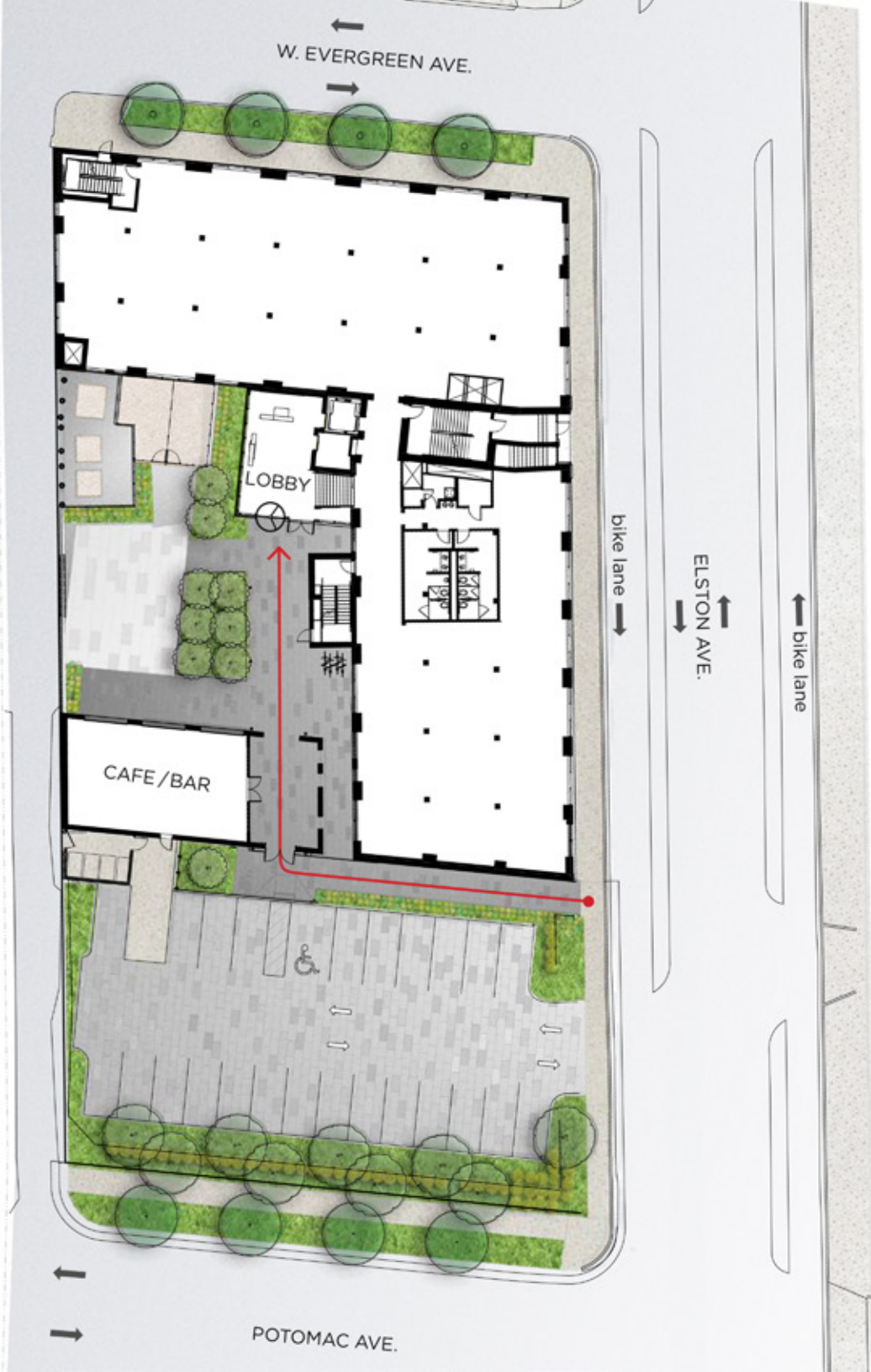



# FLOOR PLAN

First Floor





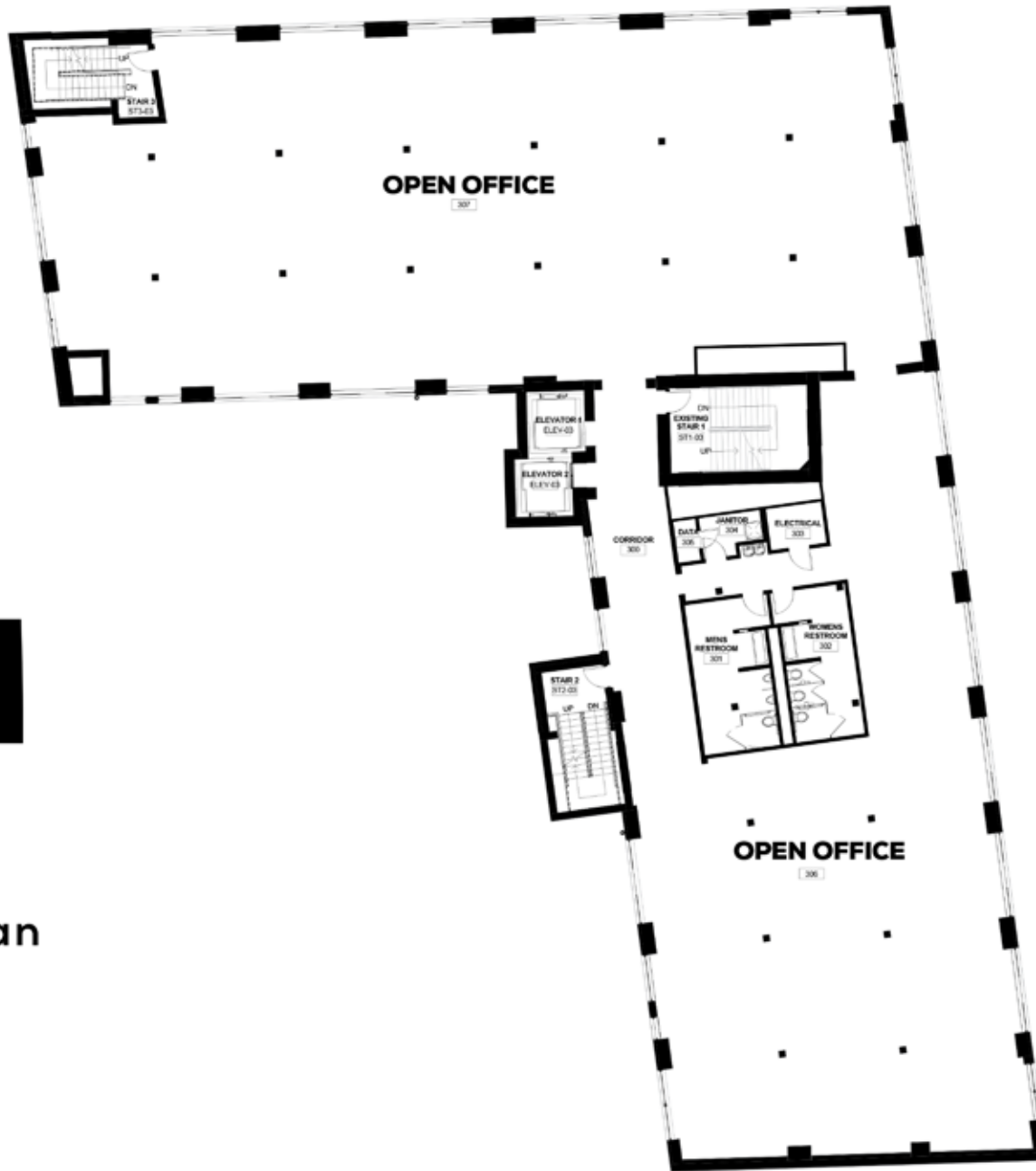

# FLOOR PLAN

Typical Floor Plan



# A FARPOINT DEVELOPMENT



**1308 NORTH  
ELSTON**

[1308elston.com](http://1308elston.com)

The team that converted 1k Fulton from cold storage into high-tech office, redeveloped 111 N. Canal into the West Loop's tech-tenant hub, and won awards for the reimagined corporate headquarters at 400 S. Jefferson now has its focus on 1308 N. Elston.

Expect great things at this one-of-a-kind location.

Ari Topper, CFA  
[ari@baumrealty.com](mailto:ari@baumrealty.com)  
312.275.3113

Tyler Dechter  
[tyler@baumrealty.com](mailto:tyler@baumrealty.com)  
312.275.3132

  
FARPOINT

  
GRECO | DEROSA  
INVESTMENT GROUP

 BAUM  
REALTY GROUP