

# 1051 Lake Street

Hanover Park, IL | 60133

# Available

Retail Or Restaurant Opportunity With Drive-Thru



- ▶ ±8,800 SF single-story brick building available for lease, divisible to ±3,000 SF
- ▶ Options available for ±2,800 SF restaurant with drive-thru or ±6,000 SF building pad
- ▶ Join Shoot Point Blank Range & Gun Shop and a soon to be announced national QSR
- ▶ Signalized corner with excellent visibility along US-20 / Lake Street (34,100 VPD)
- ▶ Adjacent to 550-acre Turnberry Lakes International Business Center
- ▶ Immediate access to I-390, close proximity to I-290 & I-355
- ▶ Area tenants include McDonald's, Wendy's, Caputo's Fresh Market, U.S. Bank, Denny's, Green Valley Golf Range and more

## DEMOGRAPHICS

	1 MILE	3 MILES	5 MILES
Estimated Population	10,010	105,133	289,679
Adj. Daytime Demographics	8,807	86,006	228,221
Estimated Households	3,335	35,706	102,193
Estimated Average Household Income	\$97,818	\$104,414	\$103,169

**ALLEN JOFFE**  
312.275.3120  
allen@baumrealty.com

**DAN MOLNAR**  
312.275.3138  
dan@baumrealty.com



© 2020 All information supplied is from sources deemed reliable and is furnished subject to errors, omissions, modifications, removal of the listing from sale or lease, and to any listing conditions, including the rates and manner of payment of commissions for particular offerings, the terms of which are available to principals or duly licensed brokers. Any square footage dimensions set forth are approximate.



# 1051 Lake Street

Hanover Park, IL | 60133

# Available

Retail Or Restaurant Opportunity With Drive-Thru



Proposed Elevations & Facade



QSR Tenant Proposed Elevations & Facade

**ALLEN JOFFE**  
312.275.3120  
allen@baumrealty.com

**DAN MOLNAR**  
312.275.3138  
dan@baumrealty.com



© 2020 All information supplied is from sources deemed reliable and is furnished subject to errors, omissions, modifications, removal of the listing from sale or lease, and to any listing conditions, including the rates and manner of payment of commissions for particular offerings, the terms of which are available to principals or duly licensed brokers. Any square footage dimensions set forth are approximate.

# 1051 Lake Street

Hanover Park, IL | 60133

# Available

Retail Or Restaurant Opportunity With Drive-Thru

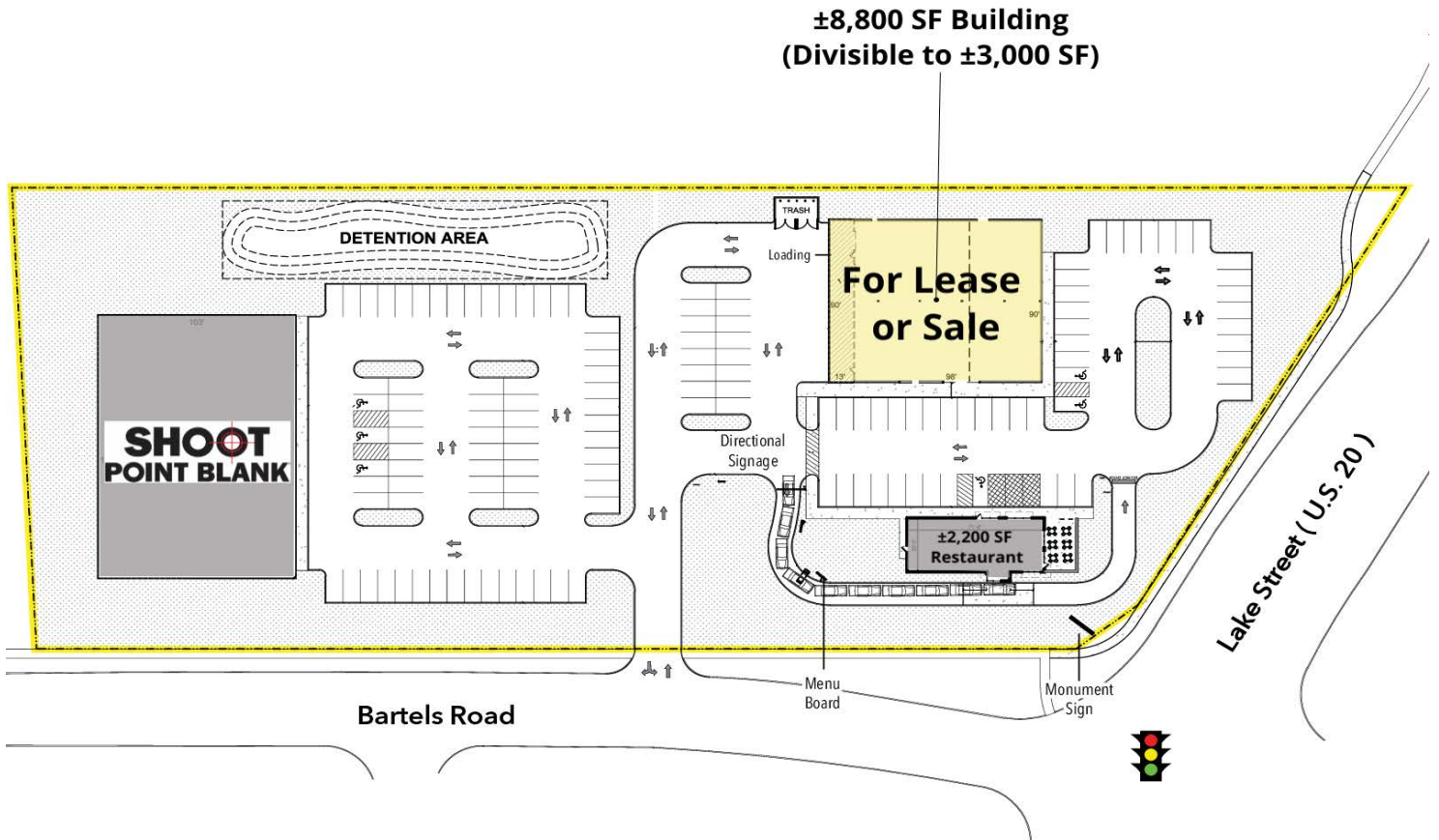

## LEGEND

Available

Unavailable

**ALLEN JOFFE**

312.275.3120  
allen@baumrealty.com

**DAN MOLNAR**

312.275.3138  
dan@baumrealty.com



© 2020 All information supplied is from sources deemed reliable and is furnished subject to errors, omissions, modifications, removal of the listing from sale or lease, and to any listing conditions, including the rates and manner of payment of commissions for particular offerings, the terms of which are available to principals or duly licensed brokers. Any square footage dimensions set forth are approximate.



# 1051 Lake Street

Hanover Park, IL | 60133

# Available

Retail Or Restaurant Opportunity With Drive-Thru

## Proposed Site Plan

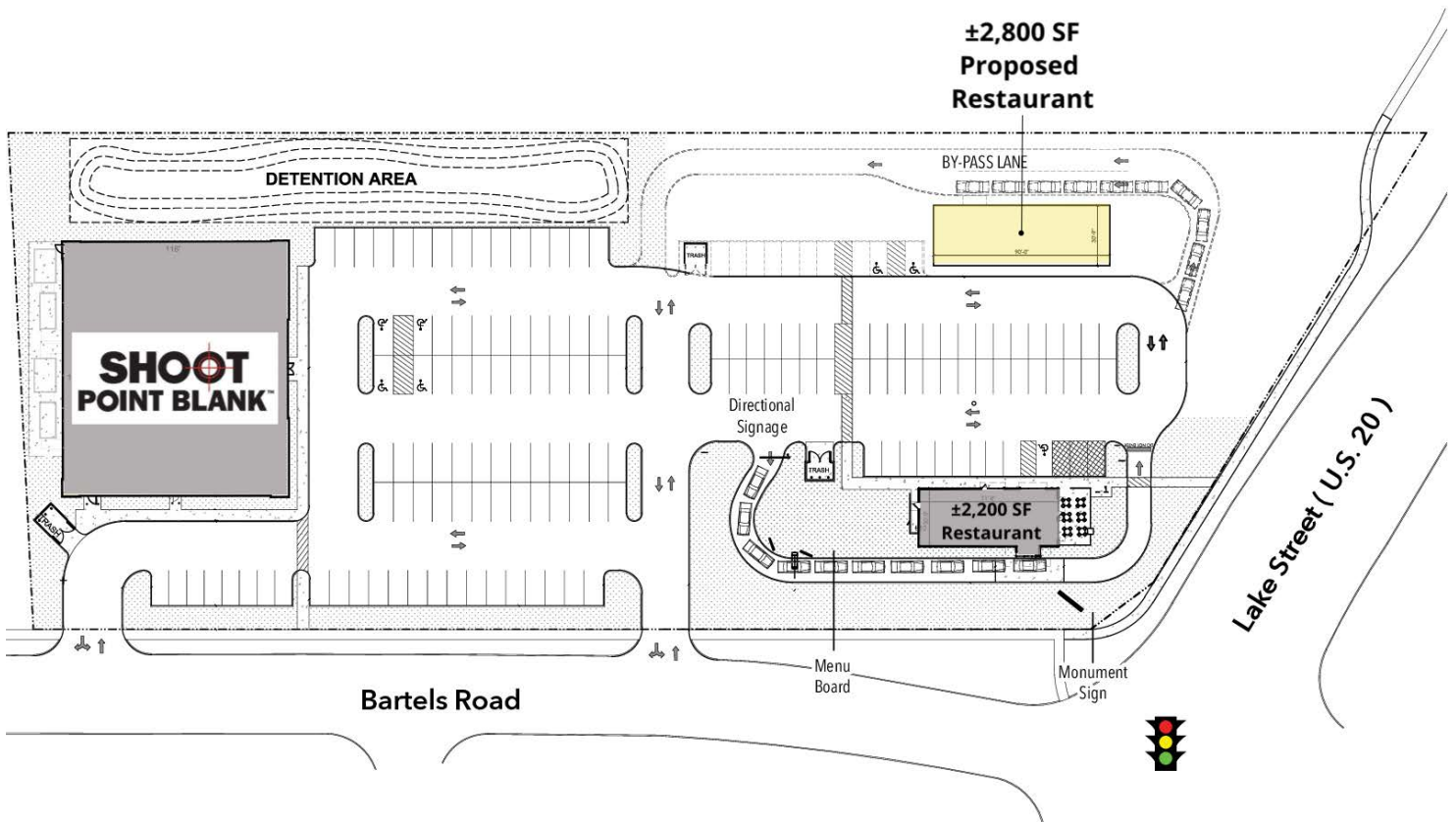

### LEGEND

Available

Unavailable

**ALLEN JOFFE**  
312.275.3120  
allen@baumrealty.com

**DAN MOLNAR**  
312.275.3138  
dan@baumrealty.com



© 2020 All information supplied is from sources deemed reliable and is furnished subject to errors, omissions, modifications, removal of the listing from sale or lease, and to any listing conditions, including the dates and manner of payment of commissions for particular offerings, the terms of which are available to principals or duly licensed brokers. Any square footage dimensions set forth are approximate.

# 1051 Lake Street

Hanover Park, IL | 60133

# Available

Retail Or Restaurant Opportunity With Drive-Thru

## Proposed Site Plan

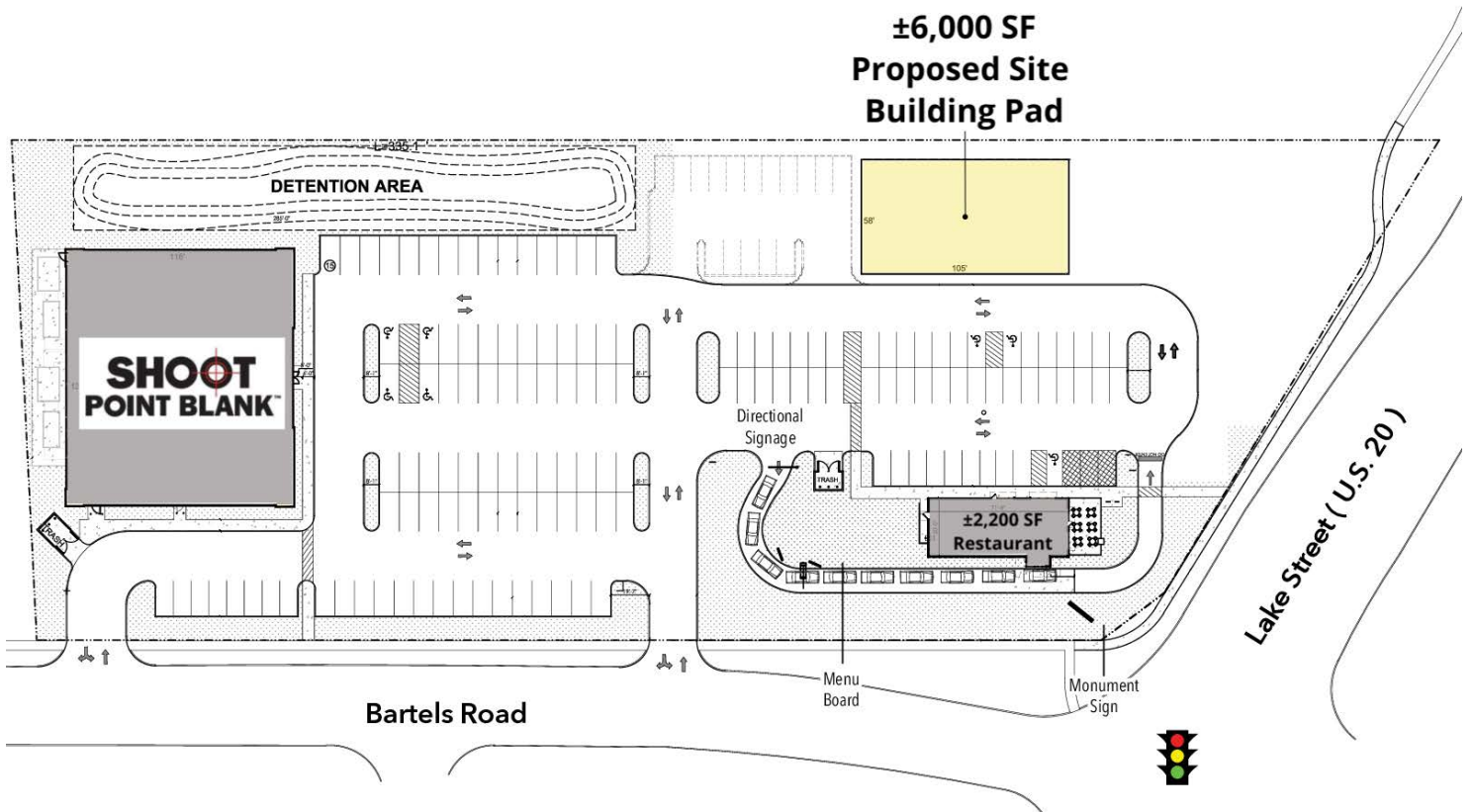

### LEGEND

Available

Unavailable

#### ALLEN JOFFE

312.275.3120  
allen@baumrealty.com

#### DAN MOLNAR

312.275.3138  
dan@baumrealty.com



© 2020 All information supplied is from sources deemed reliable and is furnished subject to errors, omissions, modifications, removal of the listing from sale or lease, and to any listing conditions, including the dates and manner of payment of commissions for particular offerings, the terms of which are available to principals or duly licensed brokers. Any square footage dimensions set forth are approximate.



1051 Lake Street  
Hanover Park, IL 60133-6645

IL 390

Illinois Pte 390

Gary Ave

Central Ave

Central Ave

Roderburg Rd  
Mensching Rd



SHOOT  
POINT BLANK

1051 E. Lake Street



34,100 VPD



Spring Wood Middle School

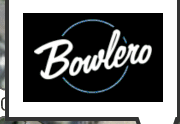

Google

Map data ©2021 Google Imagery ©2021, Maxar Technologies, U.S. Geological Survey, USDA Farm Service Agency



© 2020 All information supplied is from sources deemed reliable and is furnished subject to errors, omissions, modifications, removal of the listing from sale or lease, and to any listing conditions, including the rates and manner of payment of commissions for particular offerings, the terms of which are available to principals or duly licensed brokers. Any square footage dimensions set forth are approximate.

